

## INSTALLATION

1. Attach shower head to arm by tightening hex nut to a snug fit in a clockwise direction. Using wrench or pliers, tighten an additional  $\frac{1}{4}$  turn.
2. Adjust shower head arm to the desired position by loosening knob.
3. Test for leaks and tighten connections as needed.

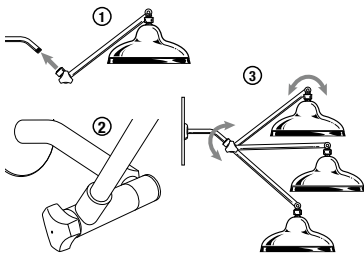

## WARNING:

- 1 To avoid hot water dangers and conserve even more energy, make sure your water heater is set at 120°F (48.9°C) or below.
- 2 Test the tub/shower water with your hand before bathing.
- 3 For additional safety it is recommended that all homes have installed a pressure balance tub and shower valve with the rotational limit stops properly set by a plumber.
- 4 **For external use only.** The potentially deadly amoeba, *Naegleria fowleri*, may be present in some tap water or unchlorinated well water.

## CARE AND CLEANING

- To clean heavier deposits, remove shower head and soak face down in 1-2 cups of white vinegar (use white vinegar only) for about 2-3 hours. Replace shower head and run in each mode to flush out vinegar.
- Do not clean or rinse any part with harsh chemicals, heavy duty cleaners, or abrasives; this may damage parts or finish and may void warranty.

## TROUBLESHOOTING GUIDE

Problem	Solution
Low water pressure or missing spray patterns.	a Clean shower head in white vinegar solution. (See care & cleaning section).
Leaking at pipe pivot ball connection.	a Confirm black restrictor is seated dome side up in hex nut. b Grate bar of soap across the j-pipe threads to act as a sealant.

## Have any questions or need assistance?

For quick service prior to calling have your model number and receipt ready.

In the U.S., call our toll-free Customer Assistance Line  
**1-800-525-2774.**

**www.waterpik.com**

Outside the U.S., write us at: Water Pik, Inc.  
1730 East Prospect Rd.,  
Fort Collins, CO  
80553-0001 U.S.A

© 2014 Water Pik, Inc. Printed in China.

FN 20018421-F AA

**DATE: 21 October 2013**      **CLIENT: Water Pik, Inc.**

**FILENAME:** 20018421-FAA\_JP-140\_instructions

**DESCRIPTION:** JP-140 instruction sheet      **FORM:** 20018421-F AA

**FILE TYPE:** Adobe InDesign CS6      **PREPARED BY:** Brian Colon

**SIZE FLAT:** 4.25" x 5.0"      **SIZE FOLDED:** N.A.      **FOLDS:** N.A.

**DIELINE:** N.A.      **INK:** Black

**PROFILE:** none