

waterpik

# Instruction Manual Manuel d'instructions Manual de instrucciones

Model # is located by barcode.

Please write your model # on your sales receipt or below.

Le numéro de modèle se trouve à côté du code-barres.

Veillez inscrire le numéro de modèle sur votre reçu de vente ou ci-dessous.

El número de modelo está ubicado al lado del código de barras.

Sírvase escribir el número de modelo en el recibo de compra o debajo.

Model Number:

www.waterpik.com/shower-register

FN 20030902-F AA

## INSTALLATION

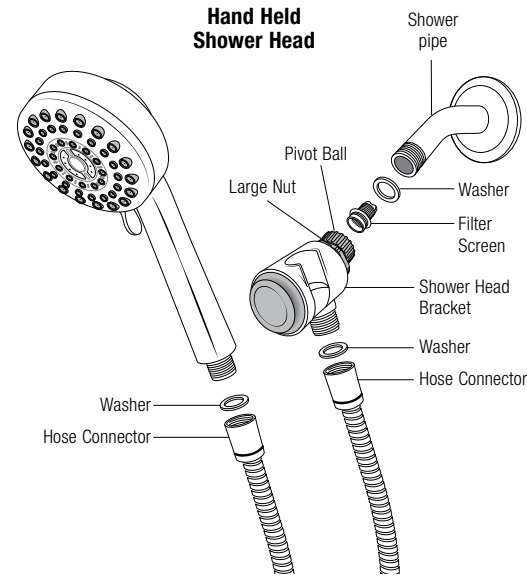

## ENGLISH

Thank you for purchasing this Waterpik® shower head. This booklet provides information to make installation easy and quick. You are close to enjoying a powerful and invigorating shower experience with your new Waterpik® shower head.

You can view more information about Waterpik® shower head products at [www.waterpik.com](http://www.waterpik.com). To learn more about Waterpik® water for wellness® benefits go to [www.waterpikwellness.com](http://www.waterpikwellness.com).

**Note:** Pictures shown may not directly match your shower head.

## PRIOR TO INSTALLATION

- Remove old shower head and remove all pipe tape.
- Ensure that the washer from the old shower is not connected to the shower pipe. Use a thin utensil to check inside the shower pipe for washers, such as a pencil or screw driver. **Do not use your fingers.**
- Gather the tools necessary to install your new shower head.

## TOOLS YOU MAY NEED

- Tools may be needed for removal of old shower head or tightening new shower head.



## Vacuum Breaker Backflow Prevention

**Note:** Several U.S. state and local municipal plumbing codes require the use of a backflow prevention device when installing a hand shower. This device is termed a vacuum breaker. If your hand shower includes a vacuum breaker it will be located in the hose, and the hose end with the vacuum breaker will include a sticker that reads "attach this vacuum breaker end to shower bracket." If the hose is not installed in this manner, water will not flow. If your hand shower does not include a vacuum breaker, and you would like to obtain one free of charge, please contact us at **1-800-525-2774** (U.S. calls only) and request part number 20009558.

## SPECIAL FEATURES

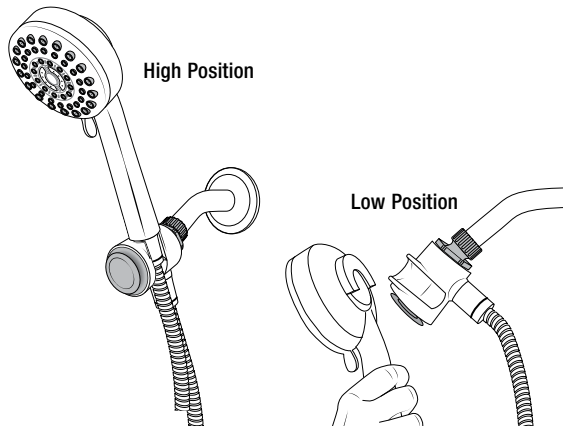

### Multi-Height Shower Docking

This hand held can be docked in two positions. Place it in the side of the bracket for a higher position or click the back of the hand held into the front bracket for a lower position.

## OPERATION

### Spray Selector:

Spray Selector allows you to select from various spray patterns. Spray pattern is controlled by the small lever that rotates left and right. Rotate the face of the shower head to change settings.

### EasySelect® Mode Shift (some models):

On some models spray pattern is controlled by an EasySelect® switch in the handle that also controls the pause feature. Each time the switch is moved up the shower head changes to the next spray setting. Moving the switch down will pause the water flow to a trickle.

### WARNINGS:

- To avoid hot water dangers and conserve even more energy, make sure your water heater is set at 120°F (48.9°C) or below.
- Test the tub/shower water with your hand before bathing.
- For additional safety for Ecoflow® or high efficiency shower heads, it is recommended that all homes have installed a pressure balance tub and shower valve with the rotational limit stops

properly set by a plumber. If you are unsure of your valve type consult your plumber.

- For external use only.** The potentially deadly amoeba, *Naegleria fowleri*, may be present in some tap water or unchlorinated well water.
- Always ensure the hand held shower head is properly placed in the bracket, so as to prevent the shower head from falling.
- Do not pull on or tug the flexible hose. This may result in the shower head coming loose and falling.

## CARE AND CLEANING

- To maintain proper working conditions cleaning is required when mineral deposits appear on the spray orifices. To clean mineral deposits, gently rub the rubber nozzles on the face of the shower head to dislodge.
- To clean heavier deposits, remove shower head and soak face down in 1-2 cups of white vinegar (use white vinegar only) for about 2-3 hours. Replace shower head and run in each mode to flush out vinegar. Repeat as necessary.

- Do not clean or rinse any part with harsh chemicals, heavy duty cleaners, or abrasives; this may damage parts or finish and will void warranty.**

- Clean filter screen by unscrewing from the pivot ball and rinse by back flushing to remove particles. Follow steps 1-3 under installation to reinstall shower head, making sure washer is re-seated on top of filter screen.

## TROUBLESHOOTING GUIDE

Problem	Solution
No water flow from installed shower head.	a Confirm previous shower washer is not in the shower pipe. b Confirm there is only one washer in the pivot ball.
Low water pressure or missing spray patterns.	a Clean shower head in vinegar/water solution. (See care & cleaning section). b Clean filter screen.
Leaking at pipe/pivot ball connection.	a Confirm only one washer is seated on top of the screen. b Grate bar of soap across the shower pipe threads to act as a sealant. c Make sure all pipe tape is removed from shower pipe. Please refer back to installation instructions for pipe tape.

Bracket is too stiff to change angle.	a Install bracket to provide additional leverage to change angle of spray (contact Water Pik for further instructions).
---------------------------------------	---

## LIFETIME LIMITED WARRANTY

**Save your receipt as proof of purchase is required for warranty action.** Water Pik, Inc. warrants to the original purchaser of this product that it is free from defects in material and workmanship for as long as the original purchaser owns this product. Water Pik, Inc. will replace the product, which in our opinion is defective, provided that the product has not been abused, misused, altered or damaged after purchase. This includes damage due to use of tools or harsh chemicals. In the event an item has been discontinued, we will replace with what we deem to be the closest product. Water Pik, Inc. is not responsible for labor charges, installation, or other consequential cost. The responsibility of Water Pik, Inc. shall not exceed the original purchase price of the product. This warranty gives you specific legal rights. You may also have other rights that vary depending on where you reside.

Water Pik, Inc. disclaims all other express or implied warranties to the extent permitted by law including, but not limited to, all warranties of merchantability and fitness for a particular purpose. All implied warranties are limited to the duration of this limited warranty. Some states or provinces may not allow limitation on how long an implied warranty lasts, so above may not apply to you.

## FOR USA ONLY

**Limitation of Liability:** This limited warranty is your sole remedy against Water Pik, Inc. and it shall not be liable for any damages, whether direct, indirect, incidental, special, consequential, exemplary or otherwise, including but not limited to property damage, arising out of any theory of recovery, including statutory, contract or tort.

## BINDING ARBITRATION AND WAIVER OF RIGHT TO ASSERT MATTERS IN COURT AND RIGHT TO JURY TRIAL

By purchasing, installing, or using this product you agree that any controversy or claim arising out of or relating to your purchase, use, modification, installation, or removal of this product shall be settled by binding arbitration. The arbitrator's decision will be final and binding. Judgment on the award rendered by the arbitrator may be entered in any court having jurisdiction over the matter. Further, you agree that you will not have the right to litigate any claim arising out of or in relation to your purchase, use, modification, installation, or removal of this product in any court or to have a jury trial on that claim.

Arbitration of any matters shall be administered by the American Arbitration Association and conducted by one arbitrator in accordance with the consumer arbitration rules of the American Arbitration Association in effect at the time of filing of the demand. The venue for

all such arbitrations shall be Colorado and any such arbitration shall be subject to the Federal Arbitration Act and Colorado law.

## WAIVER OF RIGHT TO PARTICIPATE IN CLASS ACTIONS OR PURSUE CLAIMS IN A REPRESENTATIVE CAPACITY.

Further, by purchasing, installing, or using this product you agree that arbitration must be on an individual basis. This means neither you, nor we, may join or consolidate claims in arbitration by or against other purchasers or users of Water Pik, Inc. products or the general public. Additionally, you may not litigate in court or arbitrate any claims as a representative or member of a class or in a purported representative capacity on behalf of the general public, other purchasers or users of this product, other persons or entities similarly situated, or in a private attorney general capacity.

**If product malfunctions or becomes damaged, stop use immediately and contact Water Pik, Inc. for assistance.**

## Have any questions or need assistance?

For quickest service have your model number and receipt ready prior to calling.

In the U.S., call our toll-free Customer Assistance Line **1-800-525-2774**, Monday – Friday, 7:00 AM – 5:00 PM MST. English only. or visit [www.waterpik.com](http://www.waterpik.com)

In Canada, call our bilingual toll-free Customer Assistance Line **1-888-226-3042**, Monday – Friday, 7:00 AM – 5:00 PM MST. or visit [www.waterpik.ca](http://www.waterpik.ca)

© 2021 Water Pik, Inc. Made in China.

waterpik

Water Pik, Inc., a subsidiary of Church & Dwight Co., Inc.  
1730 East Prospect Road  
Fort Collins, CO 80553-0001 U.S.A.   
[www.waterpik.com](http://www.waterpik.com)

## OUTILLAGE POUVANT ÊTRE NÉCESSAIRE

- Des outils peuvent être nécessaires pour ôter l'ancienne douchette ou serrer la nouvelle.

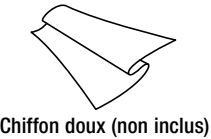

L'utilisation d'adhésif à tuyauterie n'est pas recommandée.

## INSTALLATION

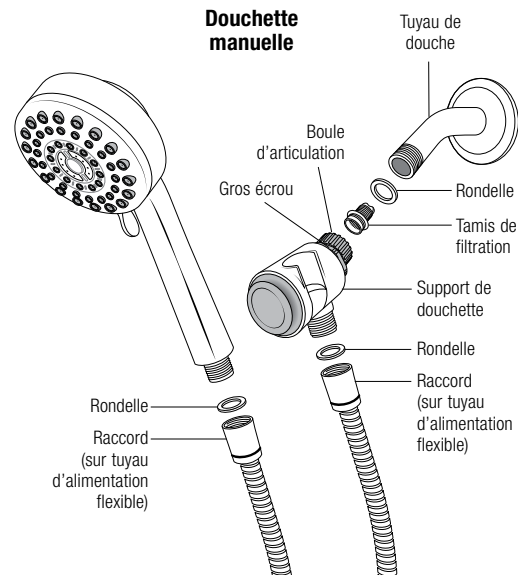

- Serrer le raccord articulé sur le tuyau. S'assurer que l'écrou est solidement fixé en le serrant à la main.
- Raccorder n'importe laquelle des extrémités du tuyau à la partie inférieure du support en tournant dans le sens horaire. Serrer à la main. (Voir la remarque ci-dessous).
- Raccorder l'autre extrémité du tuyau à la douchette à main et serrer à la main.

## Prévention de reflux avec brise-vide

**Remarque :** Plusieurs codes de plomberie fédéraux et municipaux locaux des É.-U. requièrent l'installation d'un dispositif de prévention de reflux pour l'installation d'une douchette manuelle. Ce dispositif est connu sous le nom de brise-vide. Si la douchette manuelle comprend un brise-vide, celui-ci se situe dans le tuyau et l'extrémité du tuyau avec le brise-vide comporte un autocollant sur lequel est inscrit « raccorder cette extrémité du brise-vide au raccord de douche ». Si le tuyau n'est pas installé de cette manière, l'eau ne coulera pas. Si la douchette manuelle ne comprend pas de brise-vide et que vous souhaiteriez en obtenir un sans frais, veuillez nous contacter au **1-800-525-2774** (uniquement pour les appels provenant des É.-U.) et demandez la pièce n° 20009558.

## CARACTÉRISTIQUES UNIQUES

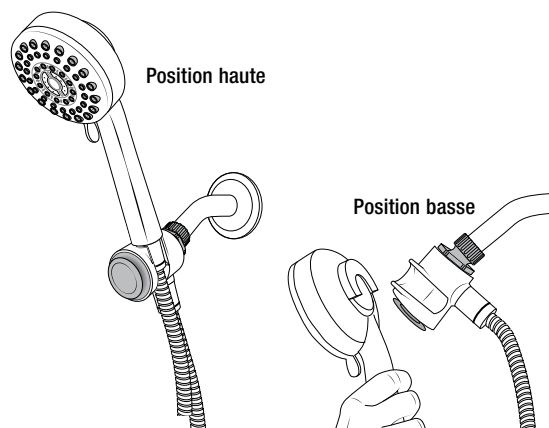

### Support de douchette à plusieurs hauteurs

Cette douchette manuelle peut être accrochée de deux façons. Placez-la sur le côté du support pour une position haute ou enfoncez le dos de douchette dans le support avant pour une position basse.

## UTILISATION DU PRODUIT

### Sélecteur du mode d'aspersion :

Le sélecteur du mode d'aspersion vous permet de choisir parmi divers réglages d'aspersion. Le réglage d'aspersion est contrôlé par le petit levier rotatif (à gauche et à droite). Tourner la douchette pour modifier les réglages.

### Sélecteur de mode avec commutateur EasySelect® (sur certains modèles).

Sur certains modèles, le mode d'aspersion est contrôlé par un commutateur EasySelect® placé sur le manche, lequel contrôle également la fonction « Pause ». Toutes les fois où le commutateur est remonté d'un cran, la douchette passe au réglage d'aspersion suivant. Placer le commutateur en position basse suspendra le débit d'eau, réduisant ainsi le débit en filet d'eau.

